

# COMPULSORY PURCHASE No.1 ORDER 2003

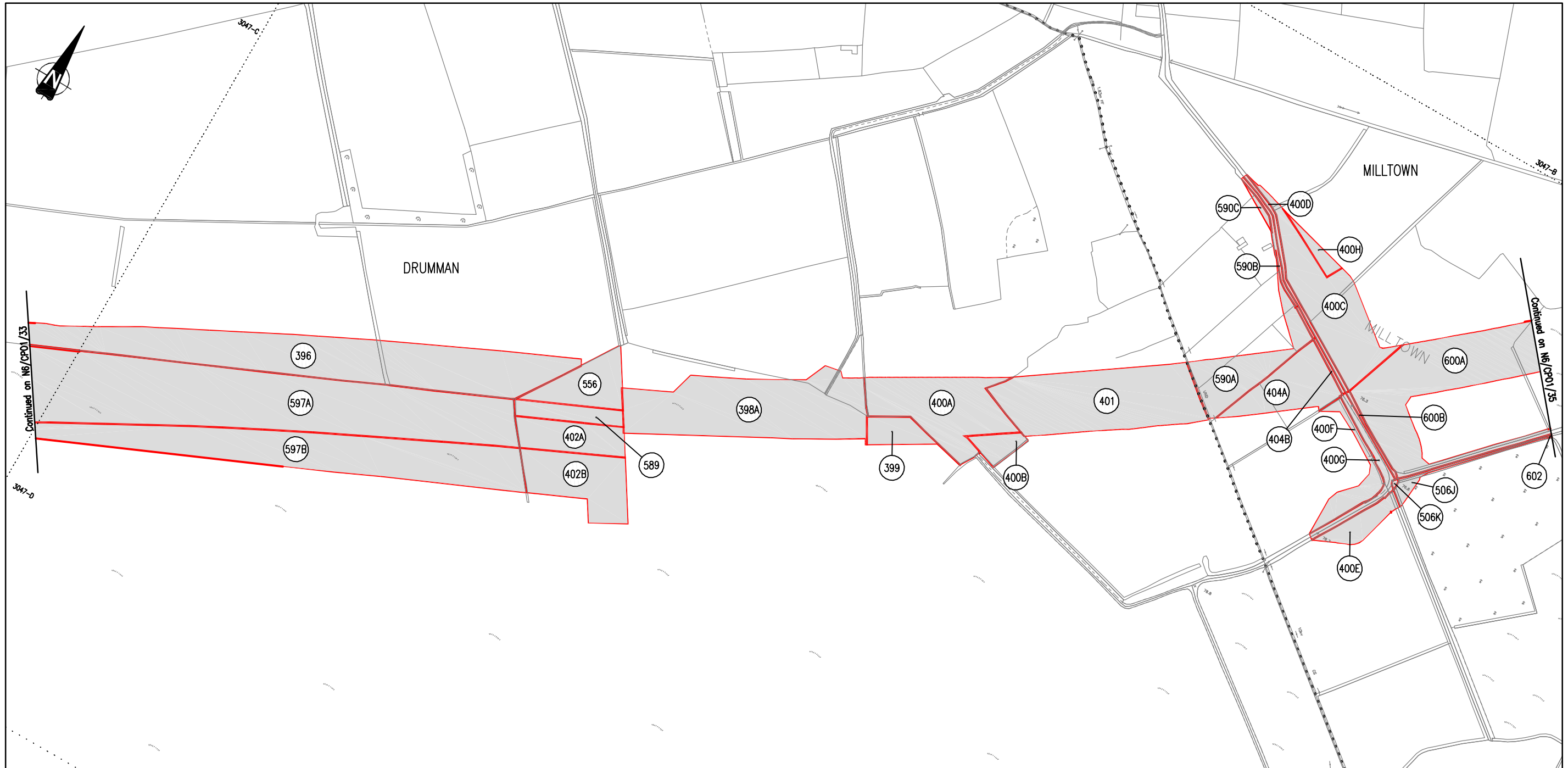

PLOTS OF LAND TO BE ACQUIRED SHOWN THUS

PRESENT WHEN THE CORPORATE SEAL OF THE WESTMEATH COUNTY COUNCIL WAS AFFIXED  SENIOR EXECUTIVE OFFICER, CORPORATE AFFAIRS  DATED THIS      DAY OF      2003	CORPORATE SEAL
---	----------------

<b>WESTMEATH COUNTY COUNCIL</b>																												
<b>N6 KINNEGAD TO ATHLONE</b>																												
<table border="1" style="width: 100%; border-collapse: collapse;"> <tr> <th style="width: 10%;">REVISION</th> <th style="width: 80%;">DESCRIPTION</th> <th style="width: 10%;">DATE</th> </tr> <tr> <td> </td> <td> </td> <td> </td> </tr> <tr> <td> </td> <td> </td> <td> </td> </tr> <tr> <td> </td> <td> </td> <td> </td> </tr> <tr> <td> </td> <td> </td> <td> </td> </tr> <tr> <td> </td> <td> </td> <td> </td> </tr> </table>	REVISION	DESCRIPTION	DATE																<table border="1" style="width: 100%; border-collapse: collapse;"> <tr> <td style="width: 30%; padding: 2px;">DRAWN D.M.</td> <td style="width: 30%; padding: 2px;">SCALE 1:2500</td> <td style="width: 40%; padding: 2px;">DRAWING No. N6/CP01/34</td> </tr> <tr> <td style="padding: 2px;">CHECKED D.W.F.</td> <td style="padding: 2px;">DATE 23/06/03</td> <td> </td> </tr> <tr> <td style="padding: 2px;">APPROVED D.H.L.</td> <td> </td> <td> </td> </tr> </table>	DRAWN D.M.	SCALE 1:2500	DRAWING No. N6/CP01/34	CHECKED D.W.F.	DATE 23/06/03		APPROVED D.H.L.		
REVISION	DESCRIPTION	DATE																										
DRAWN D.M.	SCALE 1:2500	DRAWING No. N6/CP01/34																										
CHECKED D.W.F.	DATE 23/06/03																											
APPROVED D.H.L.																												
<b>COMPULSORY PURCHASE No.1 ORDER 2003</b>																												
NATIONAL ROADS DESIGN OFFICE CULLEEN BEG MULLINGAR Co. WESTMEATH TEL (044) 34250																												