

COMPULSORY PURCHASE No.1 ORDER 2003

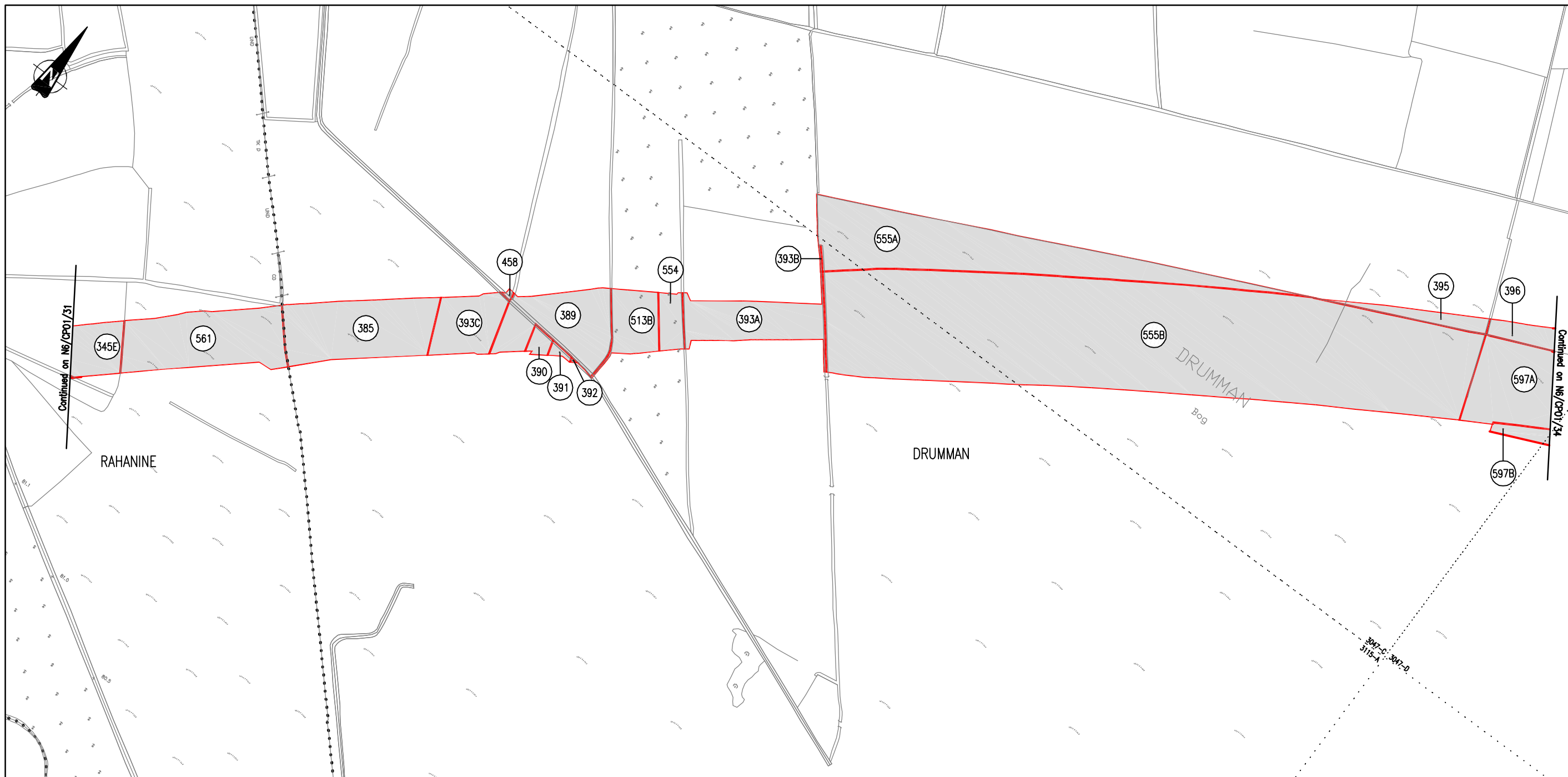

LOTS OF LAND TO BE ACQUIRED SHOWN THUS

PRESENT WHEN THE CORPORATE SEAL OF THE WESTMEATH COUNTY COUNCIL WAS AFFIXED SENIOR EXECUTIVE OFFICER, CORPORATE AFFAIRS DATED THIS DAY OF 2003	CORPORATE SEAL
---	----------------

WESTMEATH COUNTY COUNCIL																												
N6 KINNEGAD TO ATHLONE																												
<table border="1" style="width: 100%; border-collapse: collapse;"> <tr> <th style="width: 10%;">REVISION</th> <th style="width: 80%;">DESCRIPTION</th> <th style="width: 10%;">DATE</th> </tr> <tr> <td> </td> <td> </td> <td> </td> </tr> <tr> <td> </td> <td> </td> <td> </td> </tr> <tr> <td> </td> <td> </td> <td> </td> </tr> <tr> <td> </td> <td> </td> <td> </td> </tr> <tr> <td> </td> <td> </td> <td> </td> </tr> </table>	REVISION	DESCRIPTION	DATE																<table border="1" style="width: 100%; border-collapse: collapse;"> <tr> <td style="width: 30%; padding: 2px;">DRAWN D.M.</td> <td style="width: 30%; padding: 2px;">SCALE 1:2500</td> <td style="width: 40%; padding: 2px;">DRAWING No. N6/CP01/33</td> </tr> <tr> <td style="padding: 2px;">CHECKED D.J.F.</td> <td style="padding: 2px;">DATE 23/06/03</td> <td> </td> </tr> <tr> <td style="padding: 2px;">APPROVED D.H.J.</td> <td> </td> <td> </td> </tr> </table>	DRAWN D.M.	SCALE 1:2500	DRAWING No. N6/CP01/33	CHECKED D.J.F.	DATE 23/06/03		APPROVED D.H.J.		
REVISION	DESCRIPTION	DATE																										
DRAWN D.M.	SCALE 1:2500	DRAWING No. N6/CP01/33																										
CHECKED D.J.F.	DATE 23/06/03																											
APPROVED D.H.J.																												
COMPULSORY PURCHASE No.1 ORDER 2003																												
NATIONAL ROADS DESIGN OFFICE CULLEEN BEG MULLINGAR Co. WESTMEATH TEL (044) 34250																												