

COMPULSORY PURCHASE No.1 ORDER 2003

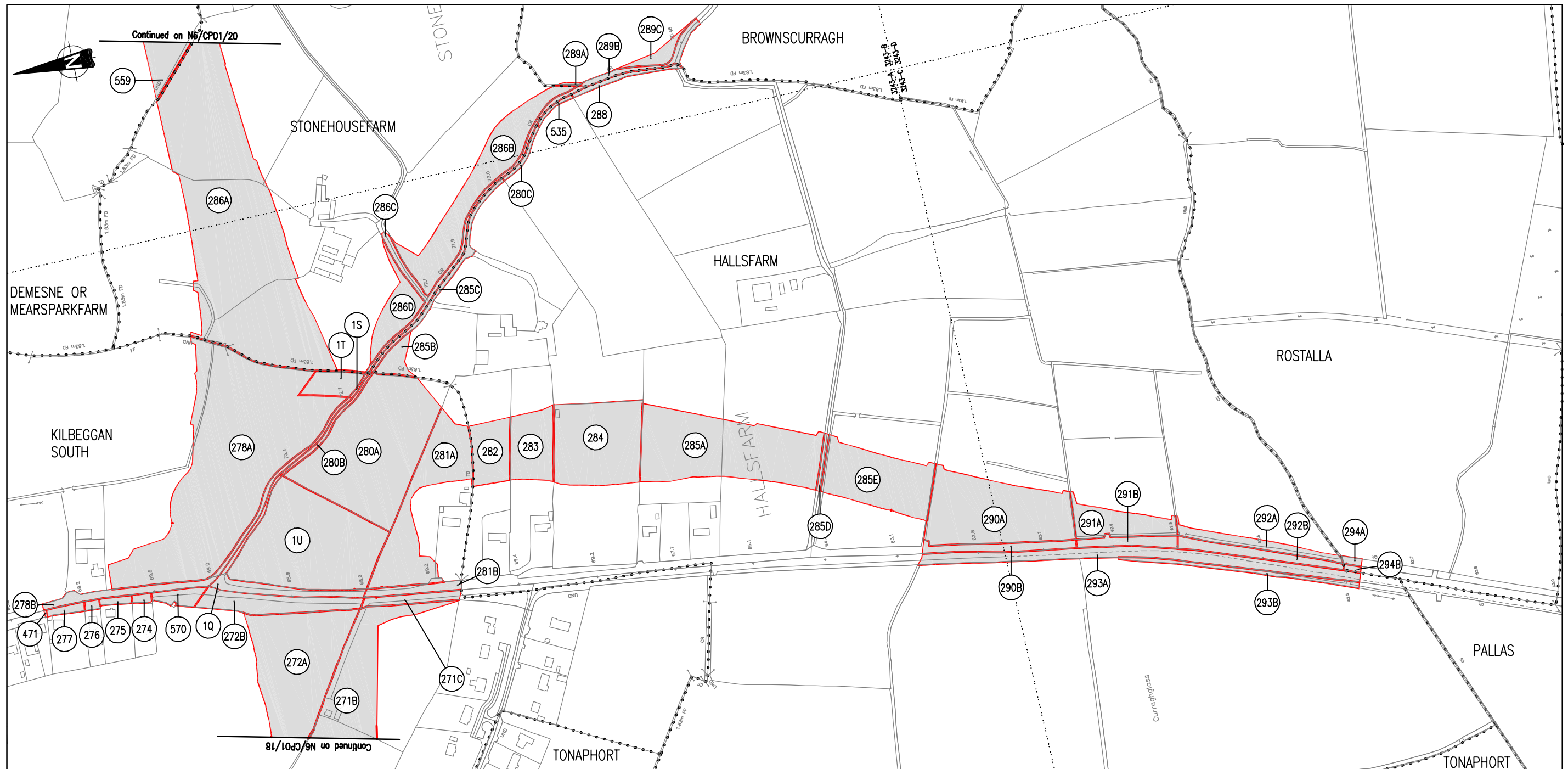

LOTS OF LAND TO BE ACQUIRED SHOWN THUS

PRESENT WHEN THE CORPORATE SEAL OF THE WESTMEATH COUNTY COUNCIL WAS AFFIXED <p style="text-align: center;">SENIOR EXECUTIVE OFFICER, CORPORATE AFFAIRS</p>	CORPORATE SEAL
DATED THIS DAY OF 2003	

WESTMEATH COUNTY COUNCIL																									
N6 KINNEGAD TO ATHLONE																									
<table border="1" style="width: 100%; border-collapse: collapse;"> <thead> <tr> <th style="width: 10%;">REVISION</th> <th style="width: 80%;">DESCRIPTION</th> <th style="width: 10%;">DATE</th> </tr> </thead> <tbody> <tr> <td> </td> <td> </td> <td> </td> </tr> <tr> <td> </td> <td> </td> <td> </td> </tr> <tr> <td> </td> <td> </td> <td> </td> </tr> <tr> <td> </td> <td> </td> <td> </td> </tr> </tbody> </table>	REVISION	DESCRIPTION	DATE													<table border="1" style="width: 100%; border-collapse: collapse;"> <tr> <td style="width: 30%;">DRAWN D.M.</td> <td style="width: 30%;">SCALE 1:2500</td> <td style="width: 40%;">DRAWING No. N6/CP01/19</td> </tr> <tr> <td>CHECKED D.J.F.</td> <td>DATE 23/06/03</td> <td></td> </tr> <tr> <td>APPROVED D.H.L.</td> <td colspan="2" style="text-align: center;"> NATIONAL ROADS DESIGN OFFICE CULLEEN BEG MULLINGAR Co. WESTMEATH TEL (044) 34250 </td> </tr> </table>	DRAWN D.M.	SCALE 1:2500	DRAWING No. N6/CP01/19	CHECKED D.J.F.	DATE 23/06/03		APPROVED D.H.L.	NATIONAL ROADS DESIGN OFFICE CULLEEN BEG MULLINGAR Co. WESTMEATH TEL (044) 34250	
REVISION	DESCRIPTION	DATE																							
DRAWN D.M.	SCALE 1:2500	DRAWING No. N6/CP01/19																							
CHECKED D.J.F.	DATE 23/06/03																								
APPROVED D.H.L.	NATIONAL ROADS DESIGN OFFICE CULLEEN BEG MULLINGAR Co. WESTMEATH TEL (044) 34250																								
COMPULSORY PURCHASE No.1 ORDER 2003																									