

# COMPULSORY PURCHASE No.1 ORDER 2003

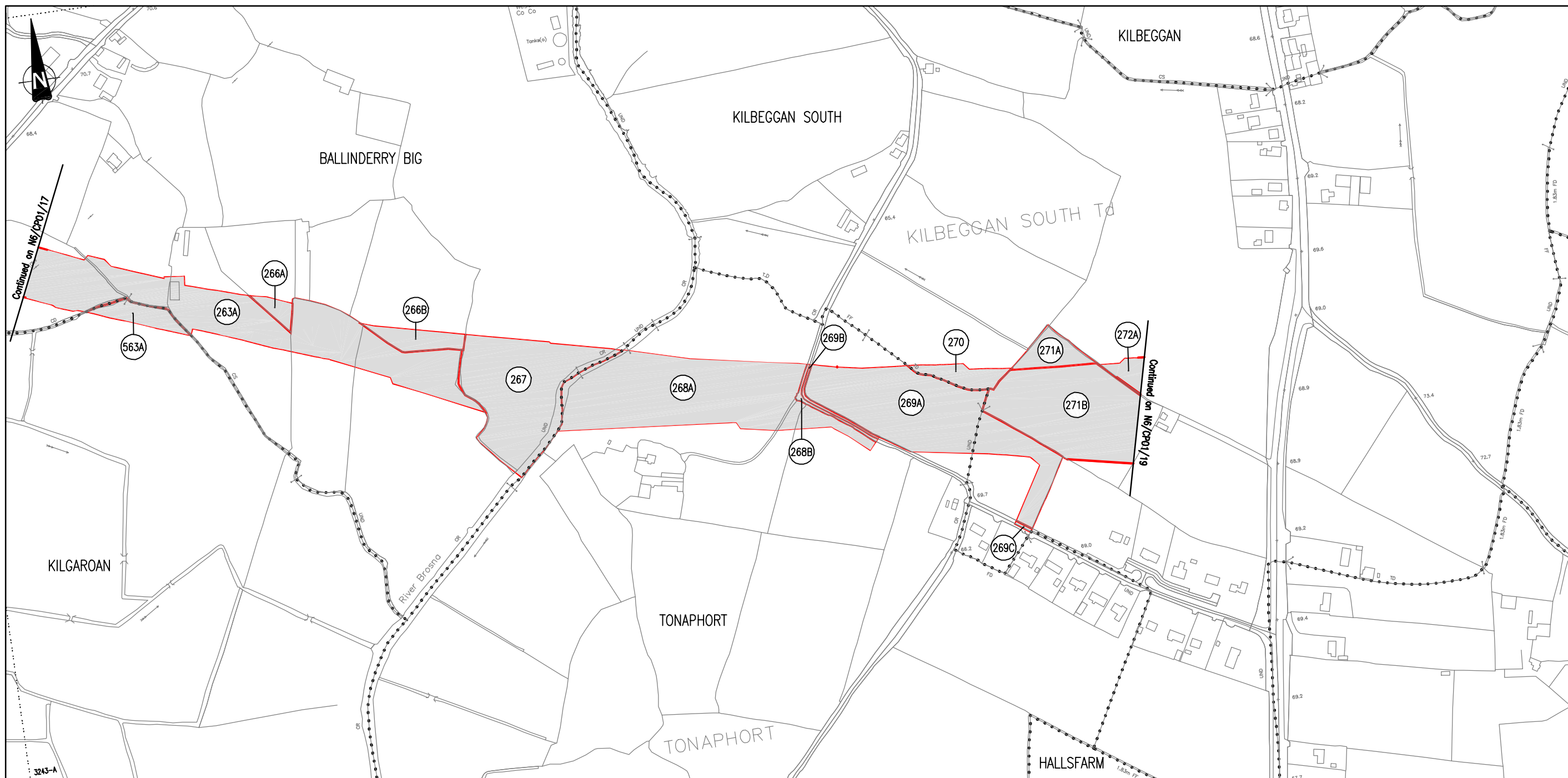

LOTS OF LAND TO BE ACQUIRED SHOWN THUS

|   |                |
|---|----------------|
| PRESENT WHEN THE CORPORATE SEAL OF THE WESTMEATH COUNTY COUNCIL WAS AFFIXED<br><br>SENIOR EXECUTIVE OFFICER,<br>CORPORATE AFFAIRS<br><br>DATED THIS      DAY OF      2003 | CORPORATE SEAL |
|---|----------------|

|  |             |                               |   |
|--|-------------|-------------------------------|---|
| WESTMEATH COUNTY COUNCIL   |             |                               |   |
| TITLE  |             |                               |   |
| N6 KINNEGAD TO ATHLONE   |             |                               |   |
| REVISION   | DESCRIPTION | DATE                          |   |
| COMPULSORY PURCHASE No.1 ORDER 2003  |             |                               | DRAWN D.M.<br>CHECKED D.W.F.<br>APPROVED D.H.L. |
|  |             | SCALE 1:2500<br>DATE 23/06/03 | DRAWING No.<br>N6/CP01/18                       |
| NATIONAL ROADS DESIGN OFFICE<br>CULLEEN BEG<br>MULLINGAR Co. WESTMEATH TEL (044) 34250 |             |                               |   |