

# COMPULSORY PURCHASE No.1 ORDER 2003

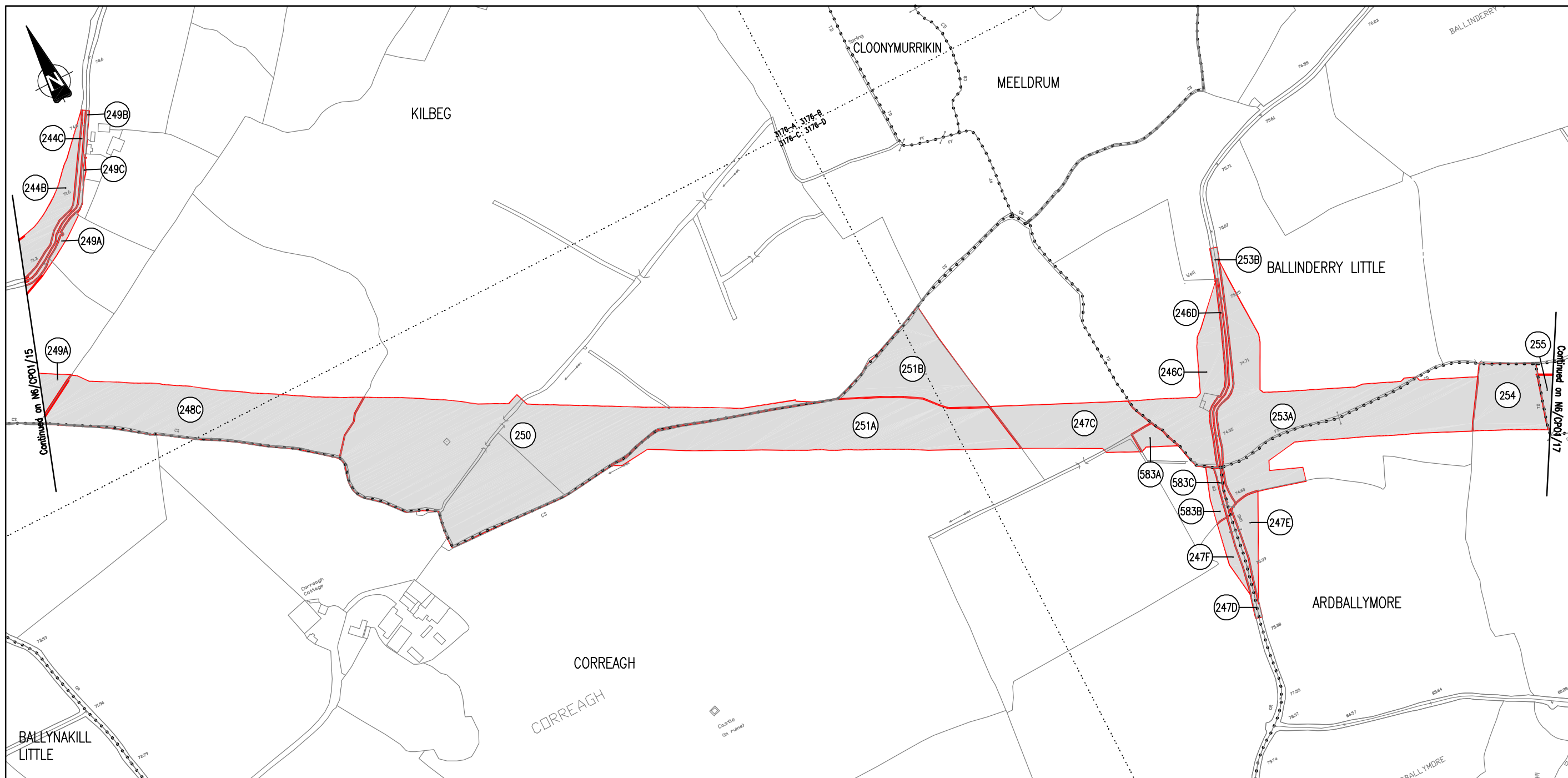

PLOTS OF LAND TO BE ACQUIRED SHOWN THUS

PRESENT WHEN THE CORPORATE SEAL OF THE WESTMEATH COUNTY COUNCIL WAS AFFIXED  <p style="text-align: center;">SENIOR EXECUTIVE OFFICER, CORPORATE AFFAIRS</p> DATED THIS      DAY OF      2003	CORPORATE SEAL
--	----------------

<b>WESTMEATH COUNTY COUNCIL</b>														
<b>N6 KINNEGAD TO ATHLONE</b>														
<table border="1" style="width: 100%; border-collapse: collapse;"> <tr> <td style="width: 50%; font-size: small;">REVISION DESCRIPTION</td> <td style="width: 50%; font-size: small;">DATE</td> </tr> <tr> <td style="font-size: small;">SUB-TITLE</td> <td></td> </tr> </table> <p style="text-align: center; font-weight: bold; margin-top: 10px;">COMPULSORY PURCHASE No.1 ORDER 2003</p>	REVISION DESCRIPTION	DATE	SUB-TITLE		<table border="1" style="width: 100%; border-collapse: collapse;"> <tr> <td style="font-size: x-small;">DRAWN D.M.</td> <td style="font-size: x-small;">SCALE 1:2500</td> <td style="font-size: x-small;">DRAWING No.</td> </tr> <tr> <td style="font-size: x-small;">CHECKED D.J.F.</td> <td style="font-size: x-small;">DATE 23/06/03</td> <td style="font-size: x-small;">N6/CP01/16</td> </tr> <tr> <td style="font-size: x-small;">APPROVED D.H.J.</td> <td colspan="2" style="font-size: x-small;">NATIONAL ROADS DESIGN OFFICE CULLEEN BEG MULLINGAR Co. WESTMEATH TEL (044) 34250</td> </tr> </table>	DRAWN D.M.	SCALE 1:2500	DRAWING No.	CHECKED D.J.F.	DATE 23/06/03	N6/CP01/16	APPROVED D.H.J.	NATIONAL ROADS DESIGN OFFICE CULLEEN BEG MULLINGAR Co. WESTMEATH TEL (044) 34250	
REVISION DESCRIPTION	DATE													
SUB-TITLE														
DRAWN D.M.	SCALE 1:2500	DRAWING No.												
CHECKED D.J.F.	DATE 23/06/03	N6/CP01/16												
APPROVED D.H.J.	NATIONAL ROADS DESIGN OFFICE CULLEEN BEG MULLINGAR Co. WESTMEATH TEL (044) 34250													